

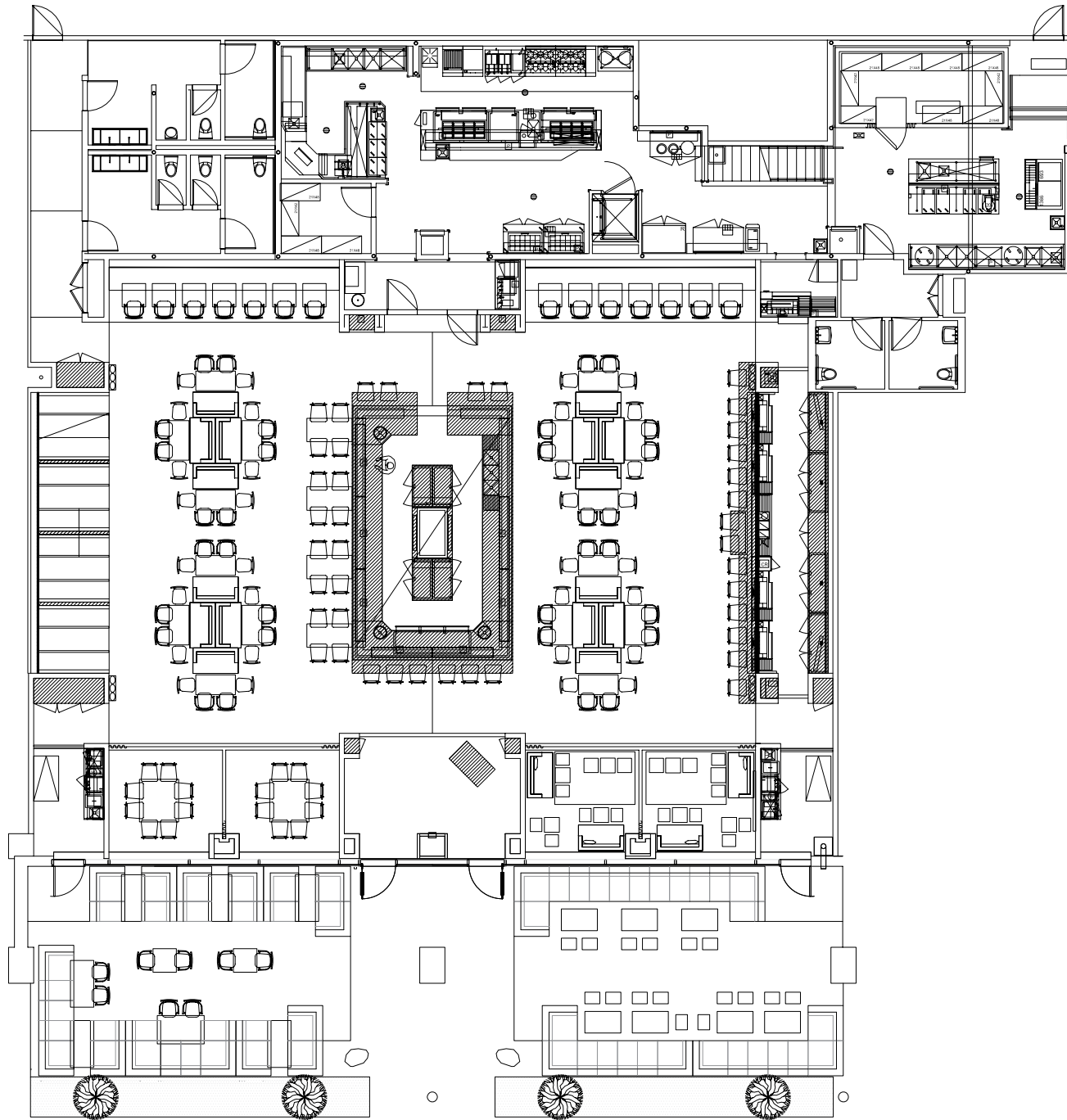

800 W. OLYMPIC BLVD.
LOS ANGELES, CA 90015
TEL. 213-747-9797
SBE.COM/KATSUYA

KATSUYA LA LIVE FLOOR PLAN:



ALSO IN THE SBE COLLECTION

SLS HOTELS • THE SAHARA LAS VEGAS • THE RITZ PLAZA SOUTH BEACH
THE BAZAAR BY JOSÉ ANDRÉS • XIV • THE ABBEY • HYDE LOUNGE • AREA
KATSUYA: BRENTWOOD • HOLLYWOOD & VINE • GLENDALE

[sbe.COM](http://sbe.com)

KATSUYA

L.A. LIVE

The fourth location of Katsuya debuted in June 2009 at downtown Los Angeles' most exciting development, LA Live, where it resides amongst a select roster of restaurants and entertainment venues including the popular Nokia Theater and adjacent Staples Center. Featuring the dynamic pairing of master sushi chef Katsuya Uechi and world-renowned designer Philippe Starck, Katsuya at LA Live also offers private dining and lounge areas as well as an expansive patio overlooking the LA Live promenade.



In addition to dining within the restaurant's stunning interior, Katsuya LA Live features a takeout service as well as off-site catering, so guests can enjoy the restaurant's renown fare - deemed "the future of Japanese cuisine" by Angeleno Magazine - at any location.

HIGHLIGHTS

Accommodates up to 400 guests

Design by Philippe Starck

Semi-private dining room accommodates up to twenty guests or two rooms of ten guests

Semi-private lounge area with two satellite TVs accommodates up to twenty guests

Full menu by Chef Katsuya Uechi featuring sushi, tempura, traditional Japanese fare and Uechi's signature creations such as Kobe filet with foie gras, grilled lamb chops and stuffed eggplant

Specialty cocktails created by a renowned mixologist, using only the freshest juices and organic ingredients

Full-service bar

Multiple flat-screen satellite TV's

Banquette seating available

Outdoor patio overlooking LA Live promenade

LOCATION

800 W. Olympic Blvd. within LA Live

Los Angeles, CA 90015

Tel. 213-747-9797

sbe.com/katsuya

RESERVATIONS

Tel. 213-747-9797 or 1-888-MY-SBE-LIFE

CONTACT

Deirdre McCready

Director of Sales

Tel. 323-525-2400

deirdrem@sbe.com

